

Masterweld TW Style MINI MIG Gun



Series	Product Information & Specs	Part Number
150 AMP MINI	MINI Gun Tweco® Style 150A .030-.035" 10' MINI Hobart	MW H-MINI-10
	MINI Gun Tweco® Style 150A .030-.035" 10' MINI Lincoln	MW L-MINI-10
	MINI Gun Tweco® Style 150A .030-.035" 10' MINI Lincoln Wirematic	MW LWM-MINI-10
	MINI Gun Tweco® Style 150A .030-.035" 10' MINI Miller	MW M-MINI-10
	MINI Gun Tweco® Style 150A .030-.035" 10' MINI LWM w/ Spade Conn.	MW T-MINI-10
	MINI Gun Tweco® Style 150A .030-.035" 10' MINI Euro	MW X-MINI-10
	MINI Gun Tweco® Style 150A .030-.035" 12' MINI Hobart	MW H-MINI-12
	MINI Gun Tweco® Style 150A .030-.035" 12' MINI Lincoln	MW L-MINI-12
	MINI Gun Tweco® Style 150A .030-.035" 12' MINI Lincoln Wirematic	MW LWM-MINI-12
	MINI Gun Tweco® Style 150A .030-.035" 12' MINI Miller	MW M-MINI-12
	MINI Gun Tweco® Style 150A .030-.035" 12' MINI LWM w/ Spade Conn.	MW T-MINI-12
	MINI Gun Tweco® Style 150A .030-.035" 12' MINI Euro	MW X-MINI-12
	MINI Gun Tweco® Style 150A .030-.035" 15' MINI Hobart	MW H-MINI-15
	MINI Gun Tweco® Style 150A .030-.035" 15' MINI Lincoln	MW L-MINI-15
	MINI Gun Tweco® Style 150A .030-.035" 15' MINI Lincoln Wirematic	MW LWM-MINI-15
	MINI Gun Tweco® Style 150A .030-.035" 15' MINI Miller	MW M-MINI-15
	MINI Gun Tweco® Style 150A .030-.035" 15' MINI LWM w/ Spade Conn.	MW T-MINI-15
	MINI Gun Tweco® Style 150A .030-.035" 15' MINI Euro	MW X-MINI-15



150 AMP MIG GUN		
Duty Cycle Using	%	Amps
CO ₂	100	150
Mixed Gas	100	95

Pennsylvania
3962 Portland Street
Coplay, PA 18037

Inweldcorporation.com
Phone: 800.346.5368
Fax: 877.346.5368
© Inweld Corporation

Texas
9300 Lawndale St.
Houston, TX 77012

REPLACEMENT GUNS & PARTS SUITABLE FOR TWECO STYLE MIG GUNS

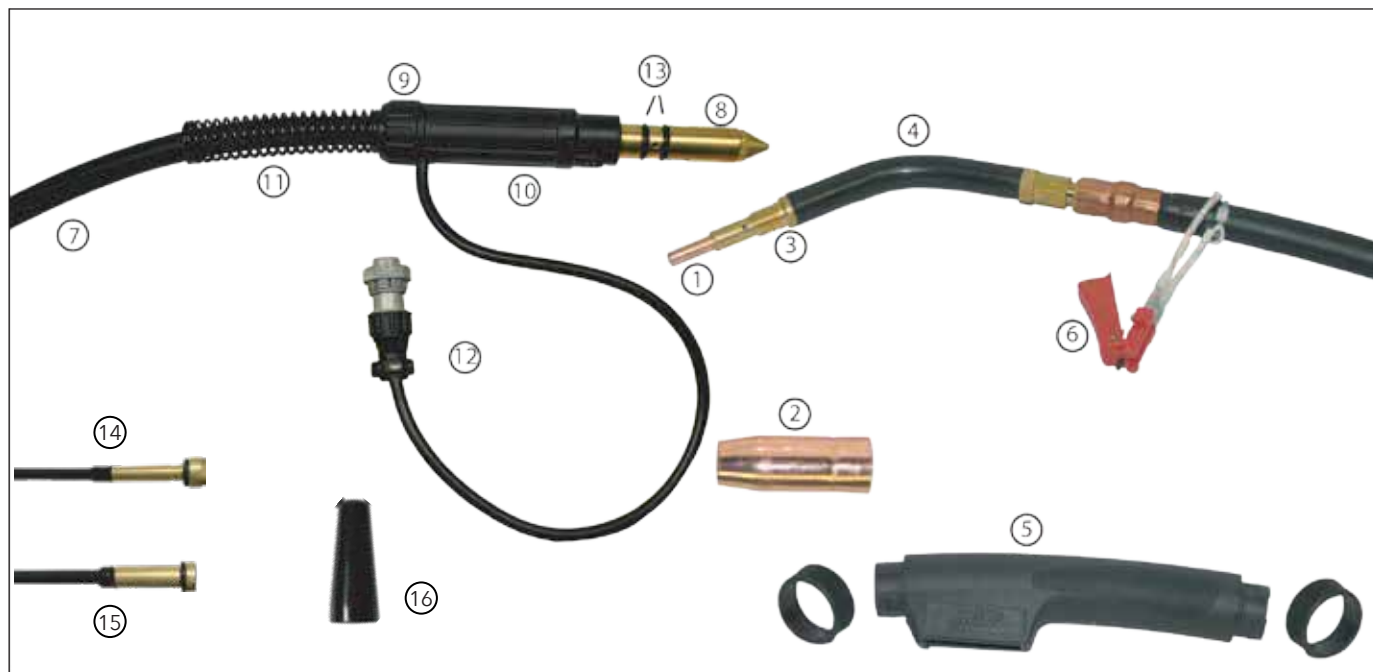

Item	Description	Inches	Millimeters	Part Number	Item	Description	Part Number
1	Contact Tip Standard Duty	0.023"	0.6mm	MW 11-23	7	Power Cable 150 Amp	MW MPC150
	Contact Tip Standard Duty	0.030"	0.8mm	MW 11-30	8	Miller Power Plug	MW 174M
	Contact Tip Standard Duty	0.035"	0.9mm	MW 11-35	9	Adaptor Support Nut	MW ASN15S
	Contact Tip Standard Duty	0.040"	1.0mm	MW 11-40	10	Adaptor Support	MW AS15S
	Contact Tip Standard Duty	0.045"	1.1mm	MW 11-45	11	Spring Support	MW 141-4S
	Contact Tip Heavy Duty	0.030"	0.8mm	MW 11H-30	12	4-Pin Amphenol Plug	MW 206429-1
	Contact Tip Heavy Duty	0.035"	0.9mm	MW 11H-35	13	O-Ring for Miller Connector	MW ORMDC
	Contact Tip Heavy Duty	0.040"	1.0mm	MW 11H-40		NS Miller™ Cone Nut	MW MPMT-M
	Contact Tip Heavy Duty	0.045"	1.1mm	MW 11H-45	16		MW TP1
	Contact Tip Heavy Duty (Alum)	3/64	1.2mm	MW 11AH-364			
2	Nozzle Standard	1/2"	12mm	MW 21-50			
	Nozzle Standard	5/8"	16mm	MW 21-62			
	Nozzle Flush	1/2"	12mm	MW 21-50F			
	Nozzle Flush	5/8"	16mm	MW 21-62F			
14	Conduit Assy (Liner) 15'/4.5m	0.023"-0.040"	0.6-1.0mm	MW 35-40-15			
15	Conduit Assy (Liner) 15'/4.5m	0.023"-0.035"	0.6-0.9mm	MW 42-3545-15			
	Conduit Assy (Liner) 15'/4.5m	0.035"-0.045"	0.9-1.1mm	MW 42-4045-15			
	Conduit Assy (Liner) Nylon 15'/4.5m	0.035"-0.045"	0.9-1.1mm	MW 42N-4045-15			
3	Gas Diffuser (Tip Holder)	0.023"	0.6mm	MW 51-23			
	Gas Diffuser (Tip Holder)			MW 51			
4	Conductor Tube Assy (Gooseneck)			MW 6M			
5	Handle Assembly			MW 8M			
6	Switch Assembly			MW 9M			

inweldcorporation.com
Phone: 800.346.5368
Fax: 877.346.5368
 © Inweld Corporation

